

Classical Conversations Egg Protector - Cycle 2

This design was created with 26 craft sticks, 35 rubber bands, plastic egg (test).



The bands are crossed over each other to make a "nest" for the egg. You will stuff the napkins around the bands to cushion impact. You could also put a few bands around the outside after you put the napkins in the protector.



After launch from 2nd floor onto concrete.
Yeah - The egg is NOT broken!!



Created with 14 craft sticks (standard), 28 rubber bands (size 31), 12 napkins and a plastic egg.

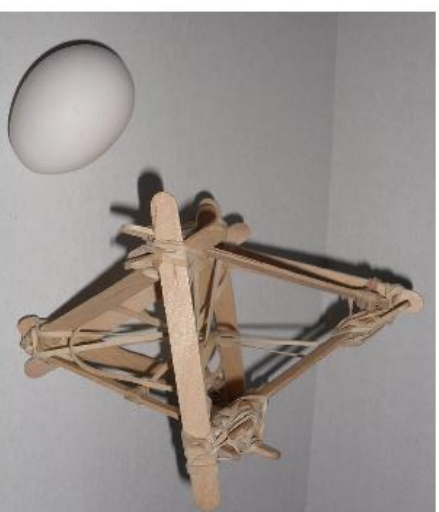

**After Launch! Yeah - no breaks!!
The design suffered no damage.**



**Prepping for launch -
note that the egg is
centered and secured
with the bands.**



**The napkins are placed around the egg to ensure
it stays centered and to cushion the impact. We
put 2 additional bands around the outside to
make sure the napkins stayed in place.**



2 Bridge Styles

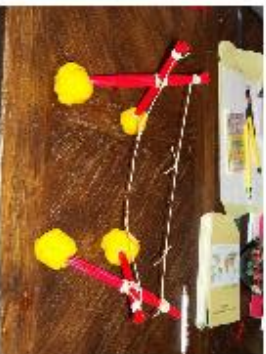

Suspension Bridge
Less than 50 straws
and bands were used.



Less than 50 straws
and bands were used.



Bridge supporting
a math book!



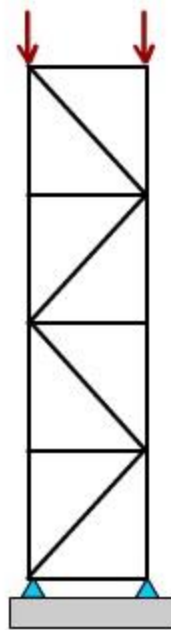
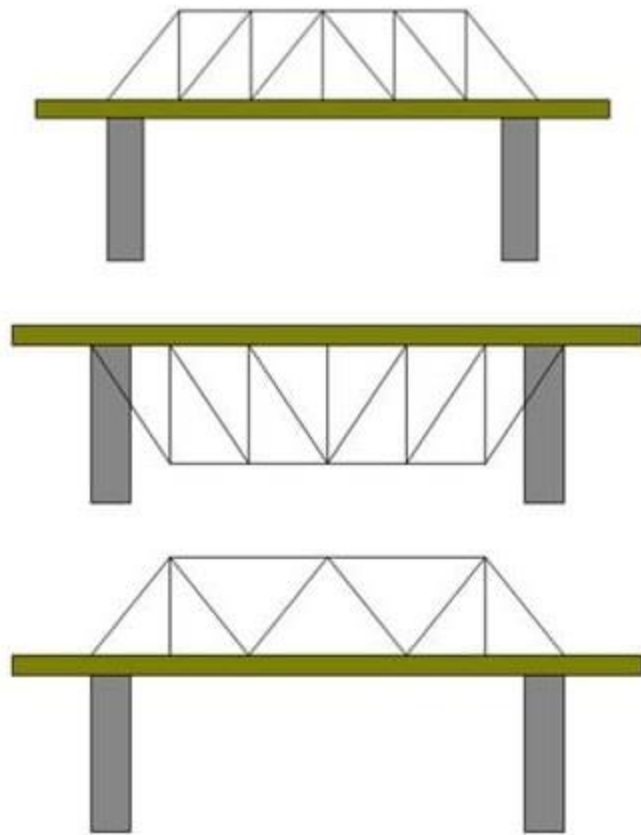

Stable Triangular Configuration

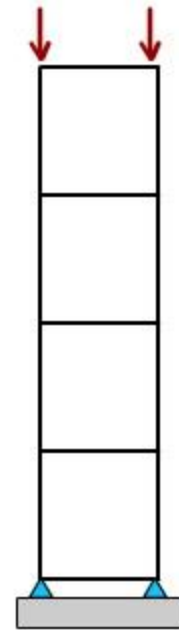

Unstable Rectangular Configuration

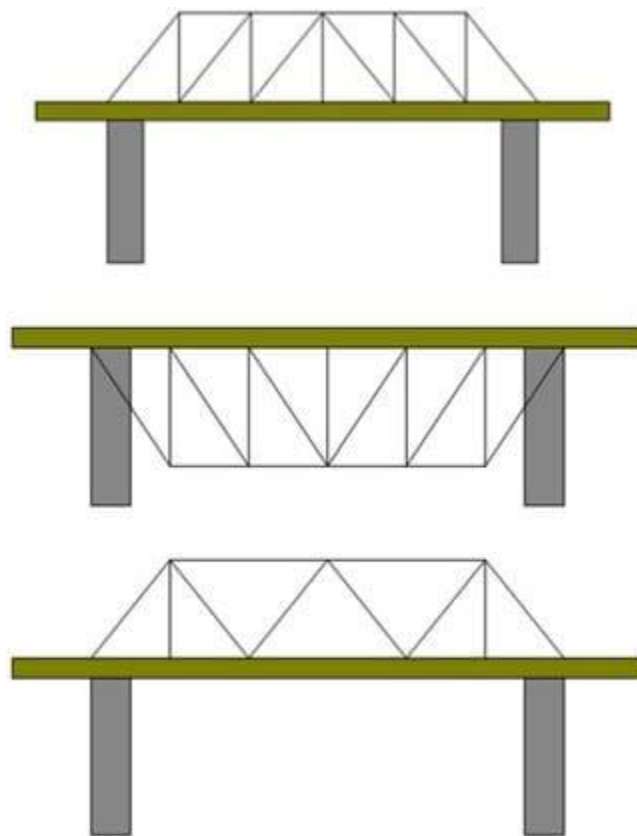

BRIDGE AND TOWER DESIGNS

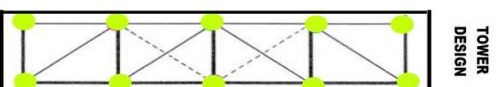
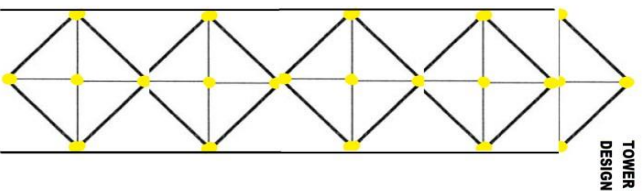
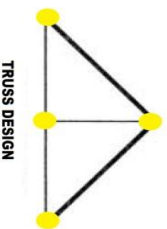
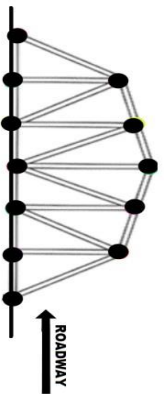
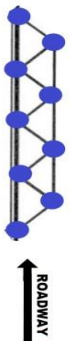
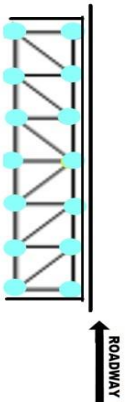
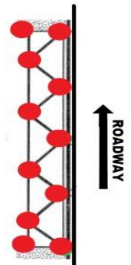
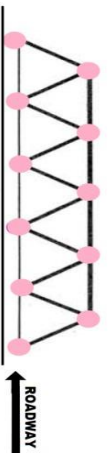
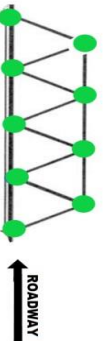
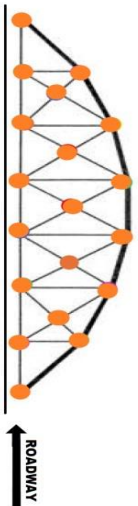

Catapult Design

